



# THAME WORKHOLDING

Field End, Thame Road  
Long Crendon, Aylesbury  
Bucks HP18 9EJ, England

Tel: 01844 208050

Email: sales@thameworkholding.com



Chuck Type:  
**KITAGAWA B 206**

Fax: 01844 201699

Web: www.thameworkholding.com

**Serrated Soft Top Jaws 1.5x60°** Slot: 12mm T-Nut to suit GP07

Jaw Type	A	B	C	Kg/Set	Material	Part No.
AS	72	35	30	1.3	080M15	BO06
AA	72	38	32	0.7	Aluminium	AA06
BS	72	30	30	1.0	080M15	BA06
AS	72	30	30	1.1	080M15	BQ06
AS	72	40	30	1.5	080M15	BB06
AS	72	50	30	1.8	080M15	BC06
AS	72	60	30	2.2	080M15	DJ06
AA	72	76	32	1.4	Aluminium	AB06
BS	82	30	30	1.3	080M15	PT06

**Full Wrap Top Jaws 1.5x60°**

DS	60	60	120	9.0	080M15	CN16
DA	64	64	120	3.2	Aluminium	HN16
DA	64	100	120	5.0	Aluminium	HN17
ES	76	76	169Ø	13.0	080M15	SG06
EA	76	76	169Ø	6.0	Aluminium	AG06

**Adjustagrip Hard Jaws - External Clamping** T-Nut to suit GP07

B	C	b	
49	35	20	590M17
Gripping Ranges			
26-47mm			LA03
37-67mm			LA04
50-81mm			LA06
64-96mm			LA07
80-112mm			LA09

**Adjustagrip Hard Jaws - Internal Clamping**

B	C	b	
49	35	20	590M17
Gripping Ranges			
45-69mm			MA05
49-80mm			MA06
68-99mm			MA07
90-122mm			MA09

**Adjustagrip Hard Bar Jaws**

B	C	Grip Range	
39	35	13-33mm	590M17 KK16

**Hard Reversible Top Jaws**

	A	B	C	S1	S2	
B	66	38	35	14		590M17 GT06
A	68	50	35	11	11	590M17 GT07

**T-Nuts**

D	H	h	K	Bolt	
12	18.5	7.5	20	M10	817M40 GP07

**Height Pins for Adjustagrips**

H	WAF	Thread	
5	10	M6	IT05
10	10	M6	IT10
15	10	M6	IT15
20	10	M6	IT20

**Quick Change Jaws**

	A	B	C	K	
Master	57	23	30	20	590M17 QK06
Standard	72	35	30		080M15 QS06
Tall	72	50	30		080M15 QT06
Pointed	80	35	30		080M15 QL06

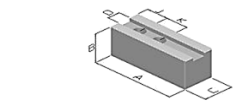

Type AS, AA

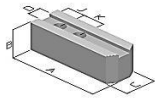

Type BS

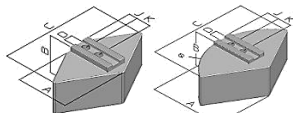

Type ES, EA

Type DS, DA

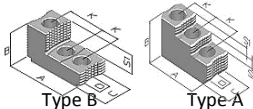
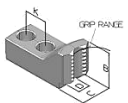
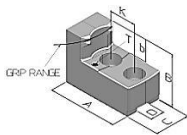
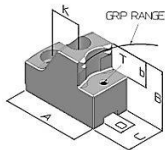

Type B

Type A

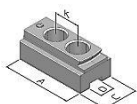
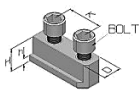

Master

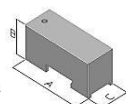

Top Jaws

**Thame Workholding also design and manufacture jaws to suit your specific workpieces.**